

REACTIONS	
STATIC	DYNAMIC
P1 1000 kg	
P2 900 kg	1800 kg
P3 450 kg	

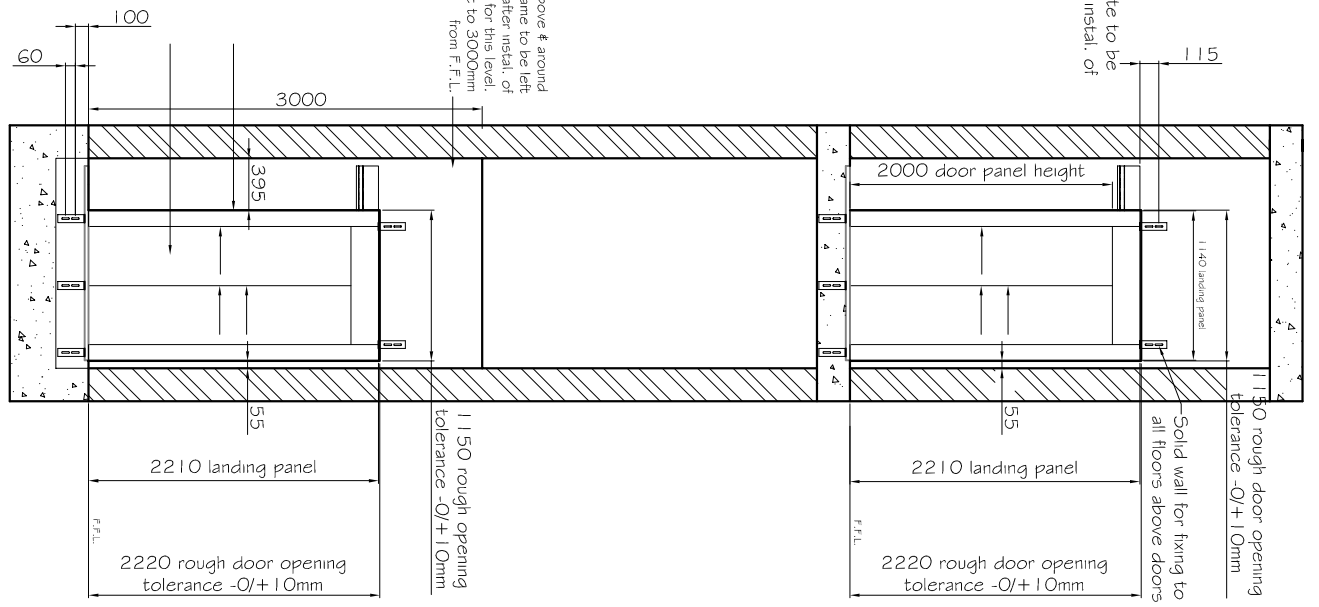
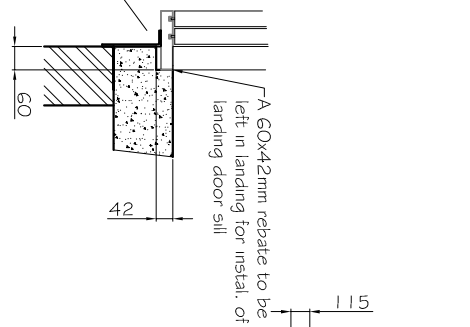
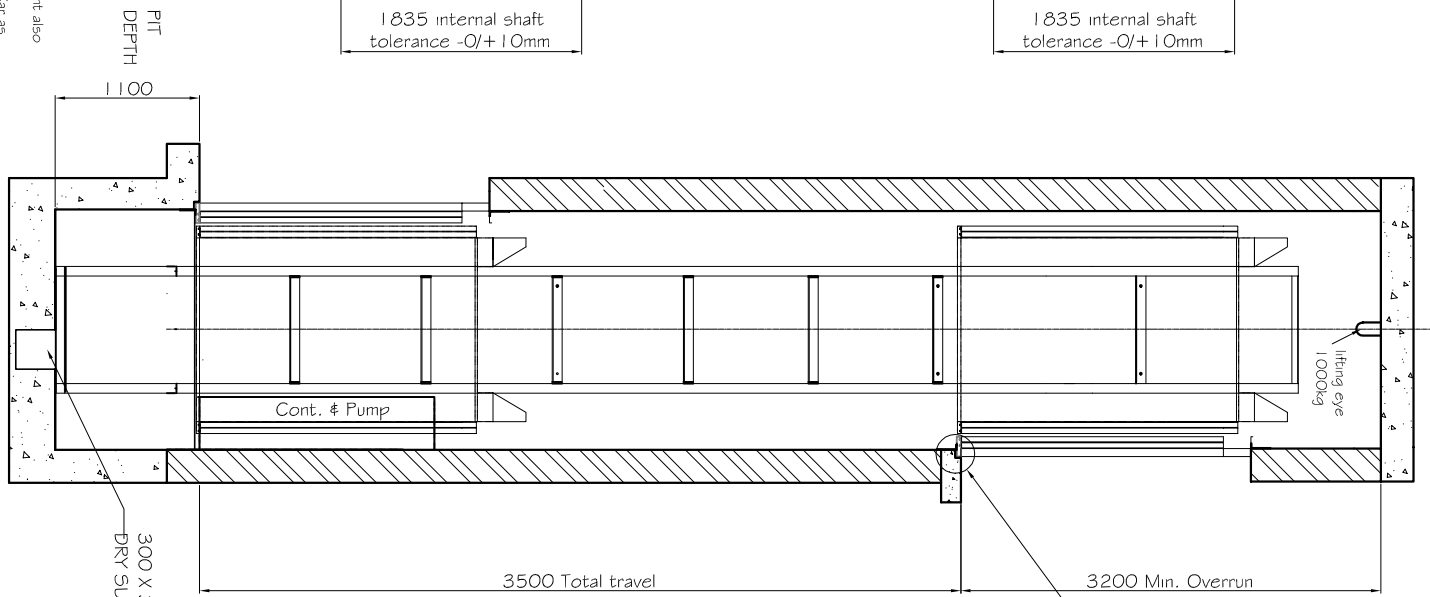
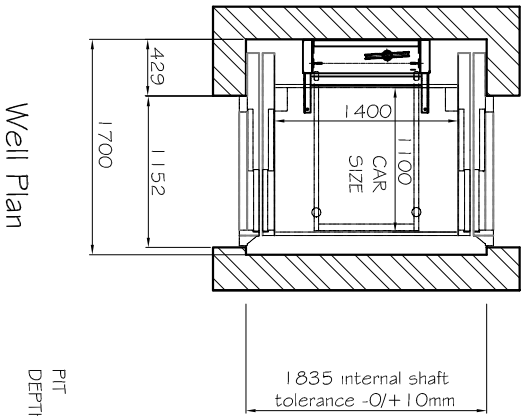

As drawn for L.H. tower. R.H. tower arrangement also available
Doors as drawn are opening from right to left. Car as drawn is single entry thru entry car also available.

Scale	N.T.S.	Layout Drawing for	Drawing No
Date	6/07/04	PART 3 HYDRAULIC	NOI 10 - A
Issue	A	LIFT B.C.A. COMPLIANT	
		Remarks	

HARWEL LIFTS